

TEXAS HEALTH CARE ASSOCIATION

RENAISSANCE AUSTIN HOTEL - PLAZA LEVEL, RIO GRANDE EXHIBIT HALL - AUSTIN, TX

REVISION

Date: 6/30/2021
Time: 10:30 am

MAP UPDATE PLANNED FOR

Date: 6/30/2021
Time: 15:00 pm

CONTACT

Angela Torres
convention@thca.org

NOTE

Booth placements are tentative until confirmed via email by THCA Staff.

BLDG. LEGEND:

- FX - Fire Extinguisher
- FH - Fire Hose Cabinet
- Ballroom Column 49"x49"
- Ballroom Column 2' Diameter
- Foyer Column 16"x16"

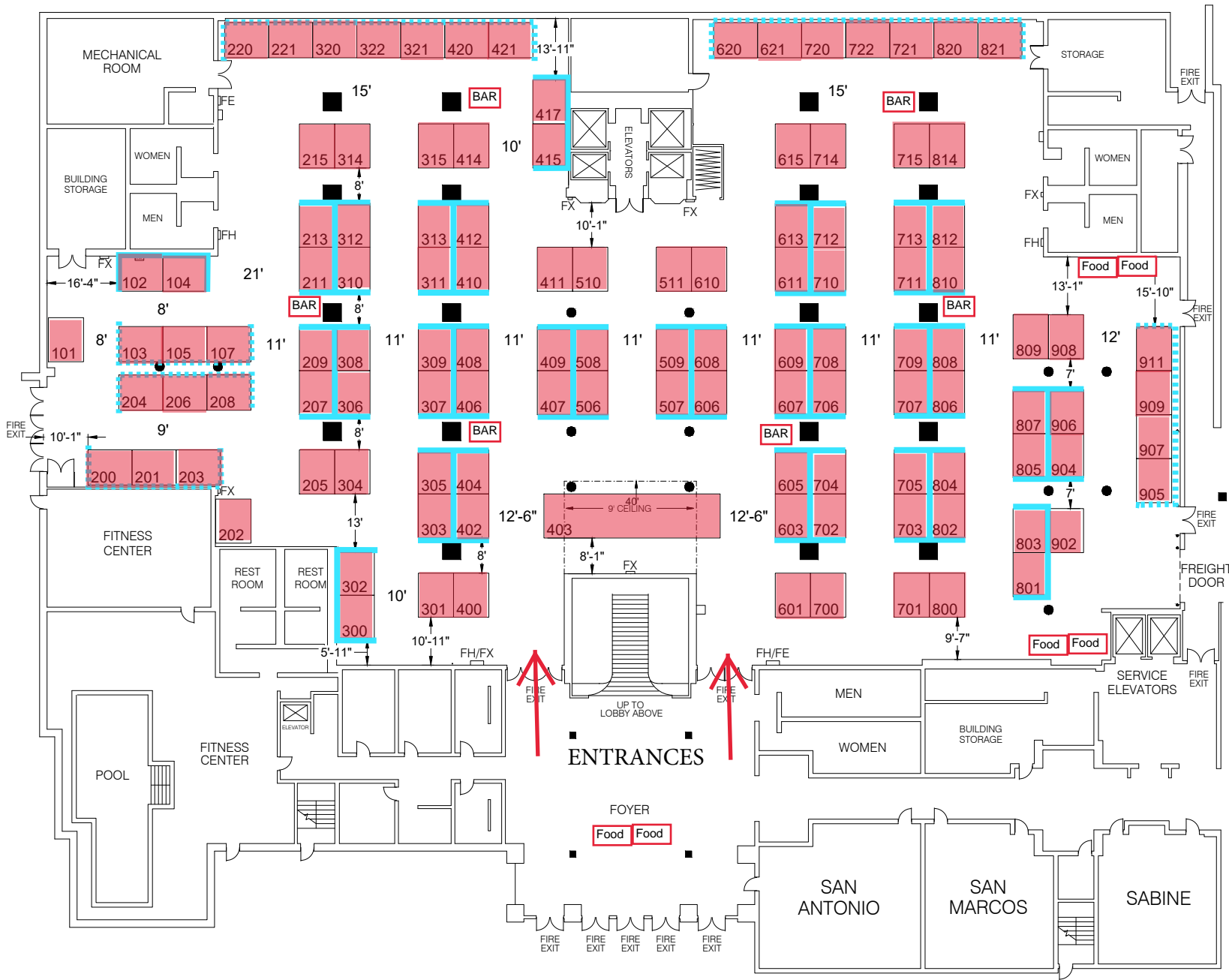

Indicates Assigned Booth

Indicates Double Booth Options

Tentative Booth Assignments

Booth placements are tentative until confirmed via email by THCA Staff.

101 Lone Star Lawyers	308 Real Time Medical Systems	508 McKesson	712 Cleanwaste
102 Prime Time Healthcare	309 Infinity Rehab	509 Molina Healthcare of Texas	713 MEDcoAmerica
103 Harmony Healthcare International (HHI), Inc.	310 Gordon Food Service	510 Pharmacy Unlimited	714 Strategic Healthcare Programs
104 Healthcare Services Group, Inc	311 BD Becton Dickinson	511 Performance Foodservice	715 Remedi SeniorCare
105 Phoenix LTC	312 Medicaid Done Right	601 Deer Oaks	720 Rich & Cartmill Inc.
107 VirtuSense Technologies	313 ENTRUST Technology	603 PHARMERICA CORPORATION	721 Synergy Care Inc.
200 Allied Medical Waste	314 KARE	605 PHARMERICA CORPORATION	722 Advantage Surgical & Wound Care
201 Essential Rehab Solutions	315 Elite Medical Staffing	606 BKD, LLP	800 Quest Healthcare, A Division of Quest Products Inc.
202 Accelerated Care Plus	320 Dynaflow Beverage	607 Reliant Rehabilitation	801 Basic American Medical Products
203 Prime Care Technologies	321 Paycor	608 Essity	802 Broussard Healthcare Consultant
204 American HealthTech	322 Kirby Restaurant & Chemical Supply	609 Reliant Rehabilitation	803 Vohra Wound Physicians
205 Pinnacle Quality Insights	400 Select Rehab	610 TridentCare	804 Broussard Healthcare Consultant
206 Auto-Chlor System	402 Ben E. Keith	611 Pharmscript	805 ShiftKey
207 Procurement Partners	403 TotalCare	613 Medline	806 Integrated Care Professionals 807 ShiftKey
208 Nexus Therapy Management LLC	404 ARKRAY USA	615 Navigator Group Purchasing	808 AMT
209 Plains Commercial	406 MChest Insitutional Pharmacy	620 New Source Medical	809 Senior Psychcare
211 CMP Pharma	407 TwinMed	621 Nutricia North America	810 Alliance Insurance Group
213 Z&D Medical Services	408 MChest Insitutional Pharmacy	700 Lument	812 TeamHealth PAC
215 Independence Rehab	409 MatrixCare	701 PointClickCare	814 Principle Health Systems
220 GeneiQ Lab	410 J-Meds	702 TMC	820 American Health Advantage of Oklahoma
221 Virtual Benefits Solutions Inc., Hearing Clinic	411 Encore Rehabilitation	703 Hartmann USA	821 Mobile Dental Care
300	412 Central Clinical Labs	704 CNH Finance	902 Austco Communications Systems
301 Direct Supply	414 PharmCare USA	705 Hireology	904 Drive DeVilbiss Healthcare
302 Cervey	415 Progressive Rehab	706 Nutritious Lifestyles	905 United Healthcare Community Plan
303 HPSI	417 Amerigroup	707 Partners Pharmacy	906 Invacare Corporation
304 First Quality Products	420 Accora Inc.	708 Sound Physicians	907 Legacy Healthcare Services
305 ACADIA Pharmaceuticals	421 Century Rehabilitation	709 Partners Pharmacy	908 Calmoseptine
306 QLTC Pharmacy Solutions	506 McKesson	710 Doctors Lab	909 CoreCare
307 Wipfli Mueller Prost	507 Molina Healthcare of Texas	711 Wise Diagnostic Systems	911 SRX